

## A76 / A79 gPV 1500VDC Fuse



### FEATURES:

- 1500V DC, 10x57mm PV fuse link
- Rated Current: 1~6A
- Max. Breaking Capacity: 10kA
- Time Constant:  $\leq 1\text{ms}$
- Special design with silver plated caps for high-power PV applications
- Reference Standard: UL2579/UL248
- Approvals: UL2549( File: E490190)

### ELECTRICAL SPECIFICATIONS

Part Number	Current Rated	Breaking Capacity	WIRE RANGE CU Only (Solid/Stranded)	I <sup>2</sup> t (A <sup>2</sup> s)		Dissipation (W)
				Pre-Arcing	Total at 1500V	100% I <sub>n</sub>
A761100b00	A7911000b0	1.0	10-12 AWG (6-4 mm <sup>2</sup> )	2	12	2.1
A761250b00	A791250b00	2.5	10-12 AWG (6-4 mm <sup>2</sup> )	3	15	2.1
A761300b00	A791300b00	3.0	10-12 AWG (6-4 mm <sup>2</sup> )	5	21	2.1
A761350b00	A791350b00	3.5	10-12 AWG (6-4 mm <sup>2</sup> )	15	56	2.2
A761400b00	A791400b00	4.0	10-12 AWG (6-4 mm <sup>2</sup> )	18	68	1.85
A761600b00	A791600b00	6.0	10-12 AWG (6-4 mm <sup>2</sup> )	60	200	2.1

**Note:** (1) DC cold resistance are measured at <10% of rated current in ambient temperature of 25°C  
(2) Typical pre-arcing I<sup>2</sup>t measured at 10 I<sub>n</sub> current

### DIMENSIONS (mm)

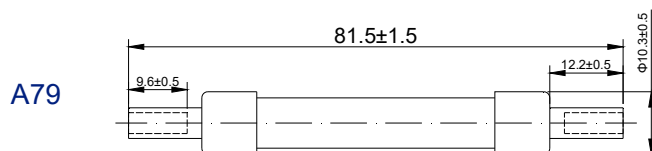
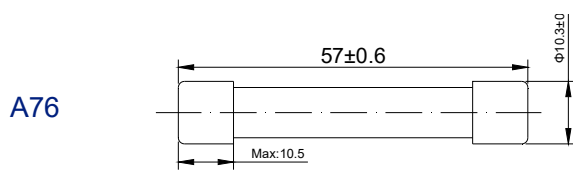

### APPLICATIONS:

- PV combiner/ junction boxes
- Inverters
- Battery Charge Controllers

### TIME VS CURRENT CHARACTERISTICS

Rated Current	100%	135%	200%
1A~6A	>4H	<1H	<4min

**Time Current Curve (reference)**

